



Characteristics

External dimensions : 1500 x 1200 x 900
 Back edge
 Front without any visible screw
 70mm space between kettle and pillars
 for an easy cleaning.
 Full drain at 400mm off the ground
 18.10 stainless steel
 Folded top edges - 2mm thickness
 Planetary finish
 2 mm thickness structure
 Pre-equipped for energy optimizer

Top

316L stainless steel tank
 Wide spout
 Tank dimensions : Ø750x570
 Net capacity : 225 l.
 Heating by dust protected high-performance
 heating elements
 Maxi pressure into the double cover: 1 bar (120°C)
 Thermostatic steam trap
 Hot/Cold water supply
 Water meter
 Heating stop while tilting
 Manually operating mode or from
 recorded recipes
 Differed start and timer
 Control by color touch screen
 Counterbalanced and doubled lid with a food trap
 Flat tank base - 5mm thickness
 Security valve
 Automatic regulation of the water level
 Control of temperature into the double jacket
 + temperature of the product
 Heating power: 35 kW

Options :

cooling of the double skin bmb by circulation of the water ne (X238005)
 water jet with extendable hose (X238006)
 draining valve 40/49 on the front panel of the kettle (X238007)
 rs output for traceability (X238009)
 stand for tilting systemat 700 mm of the ground (X238010)
 draining rack (X238011)

Base unit

Tilting by electric cylinders (IP66 without maintenance)
 Integration in the pillars allowing complete
 protection from external aggressions
 Tilting control for a real
 ease of use, hygiene and safety
 Tilting stop in any position of tank

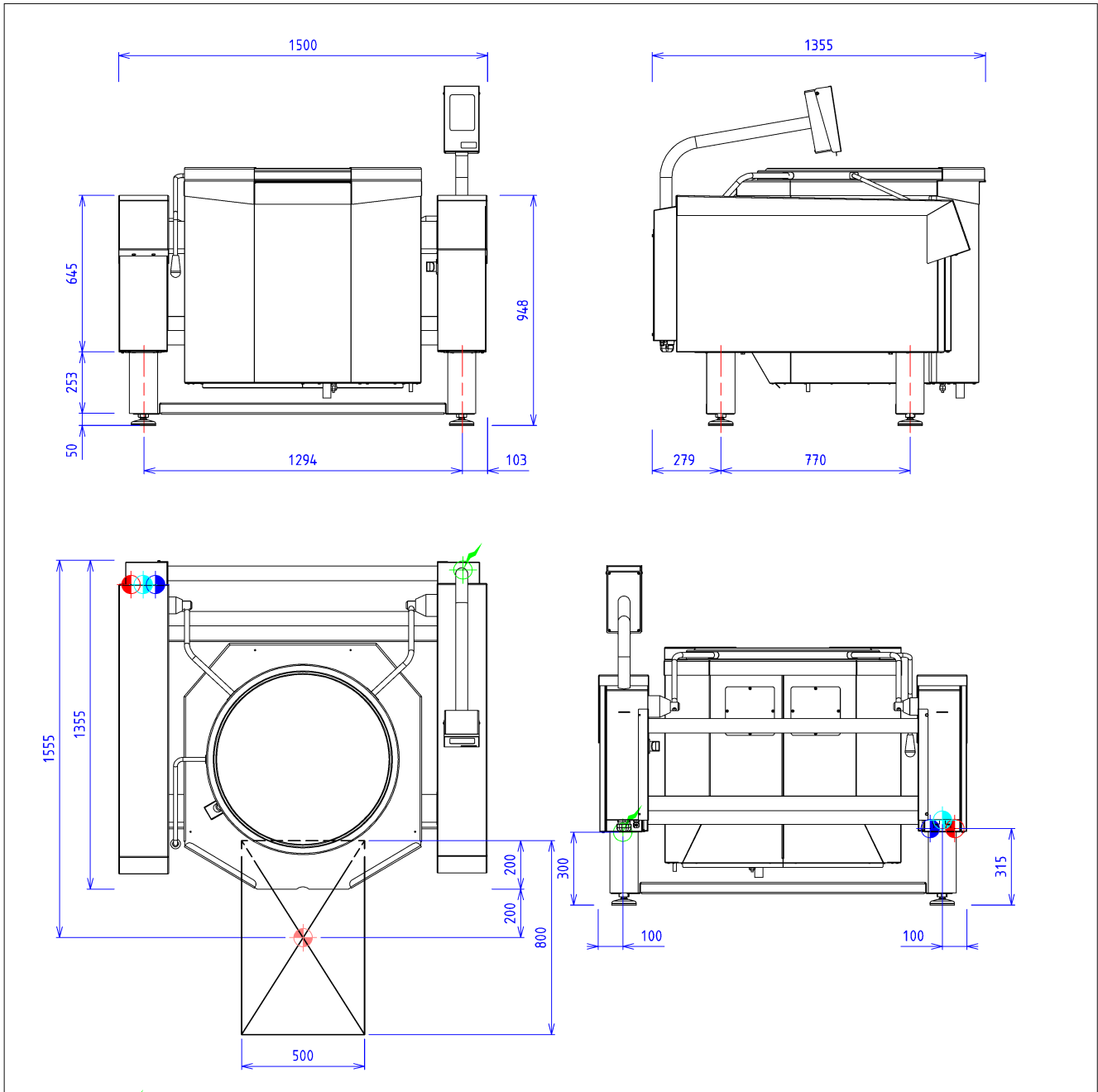

ELECTRIC



Electric power : 37.00kW

Elec Réserve : INTERNAL TERMINAL BOARD - Elec fitting : 400V THREE

Electrical devices standard to the norm EN 60-335

WATER/AIR



Hot water fitting :15/21 FLEXIBLE



Cold water fitting :15/21 FLEXIBLE



Double jacket connection in softened water :15/21 FLEXIBLE

Prévoir un régulateur de pression réglé à 1.8 Bar maxi pour le circuit de la double enveloppe