

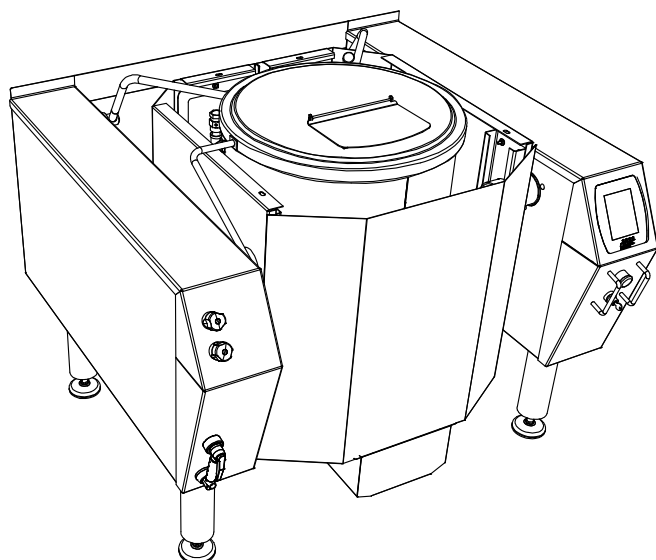

The reference in catering equipment

BAIN-MARIE KETTLE WITH MIXING ARM 150L TYPE CM GAS ELEC TILTING - HW/CW FEED

CENTRAL KITCHENS FRONT 1350



Caracteristics :

External dimensions : 1350x1200x950/1000
18.10 stainless steel
Brushed appearance
Top thickness 2 mm
Structure 2 mm in stainless steel
Back edge
Front without any visible screw
70mm space between tank and pillars
for an easy cleaning.
Full drain at 400mm off the ground

Descriptions :

Counterbalanced and doubled lid with a food trap
(18.10 stainless steel)
316L stainless steel tank
Bottom of tank thickness: 3mm
Wide spout
Tank dimensions : Ø603x600
Net capacity : 150 l.
Power: 30 kW
Heating by delivery air burner
Maxi pressure into the double cover: 0,5 bar
Security valve
Thermostatic steam trap
Hot/Cold water supply
Water meter
Drop-in by electric screw lifting jack
Heating stop while tilting
Control by color touch screen
Manually operating mode or from
recorded recipes
Thermostatic regulation
Differred start and timer
Removable mixing arm with PTFE scrapers
Programmable cycle, speed and direction of rotation

Specifications :

Tilting by electric cylinders
Protection class IP66, no maintenance
Integration in the pillars allowing complete
protection from external aggressions
Tilting controler allows reliability,
ease of use, hygiene and safety
stop at any tank

Options :

Cooling of the double skin for Bain-marie
by circulation of the water of the network (X238005)
Water jet with extendable hose (X238006)
Draining valve 40/49 on front panel (X238007)
RS output for traceability (X238009)
Stand for tilting system at 700mm off the ground (X238010)
Draining rack (8Ø standard perforation) (X238011)

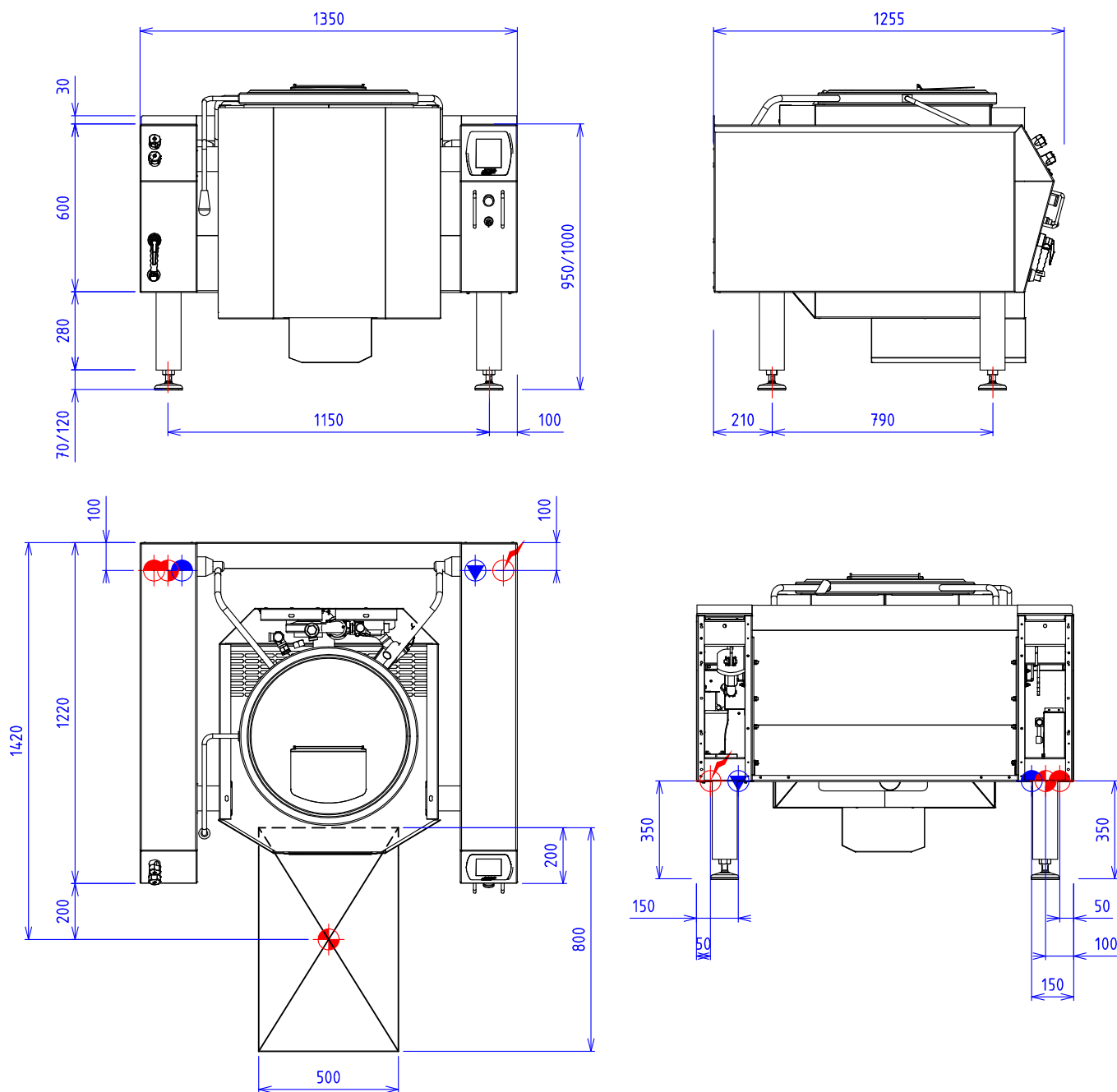

CENTRAL KITCHENS

BAIN-MARIE KETTLE WITH MIXING ARM 150L TYPE CM GAS ELEC TILTING - HW/CW FEED



GAS :  Gas power : 30kW conical 20/27 gas fitting

ELEC :  Electric power : 2 kW Elec reservation : internal wiring Elec fitting : 400Vx3+N+T

WATER :  Hot water fitting: 15/21 socket
 Cold water fitting: 15/21 socket
 Connection jacket in soft water: 15/21 socket

Provide a pressure regulator set at 1.5 bar max for the jacket

Gas devices standard to the norm NF EN 203. EN 437 / Gas Law 90/396/CEE

Electrical devices standard to the norm EN 60-335

The emblems, descriptions and diagrams of this documentation are given for your information and could be modified without notice.



69, av. des sports- 29556 QUIMPER CEDEX9-FRANCE
 tel.: 02.98.64.77.00 - fax: 02.98.52.06.47 e-mail : capic@capic-fr.com