

**MIXING ARM AND ELLIPTIC BOTTOM****Characteristics**

External dimensions : 1200 X 925 X 450  
 Stainless steel top 18.10 planetary planetary brushed finish  
 Top thickness : 3 mm  
 body 1 mm in planetary brushed stainless steel  
 Structure : 2 mm in stainless steel  
 folded front edge radius 20 mm  
 Back edge forming a chimney cover  
 Front without any visible screw  
 70mm space between kettle and pillars  
 for an easy cleaning.

**Descriptions**

1 mm stainless steel double lid  
 equipment with echtermann hinge  
 Tank and double layer in stainless steel 18.10  
 welded on the top  
 2mm thickness for the ferrule and 3mm for the bottom  
 Lid handle with insulated end  
 Immersed heater  
 into the double skin  
 Net capacity : 80 l.  
 Electronic regulation of the water level into the double skin  
 Hot/Cold water supply  
 Volumetric watermeter  
 Heating stop while tilting  
 Ring thickness 2mm  
 Elliptical bottom 3mm  
 Dimensions (ØxP) : 500x490  
 Power: 14 kW  
 Differred start + timer  
 Food trap  
 Double skinned 350grs with  
 pressure valve 500 grs  
 Thermostatic regulation  
 9 speed rotations programmed  
 Deplaced axis for draining at 300mm from the ground  
 Removable mixing arm with bottom and  
 sides PTFE scrapers

**Specification**

Tilting by electric cylinders (IP66 without maintenance)  
 Integration in the right pillar allowing complete  
 protection from external aggressions  
 Tilting control for a real  
 ease of use, hygiene and safety  
 Tilting stop in any position of tank

**Options :**

450 stainless steel feetheight 900/930 (X296001)  
handspray (X296021)  
support brackets for pilotethe pair (X299002)  
side edge straight open for assembly machineon the right side (X296041)  
side edge straight open for assembly machineon the left side (X296042)

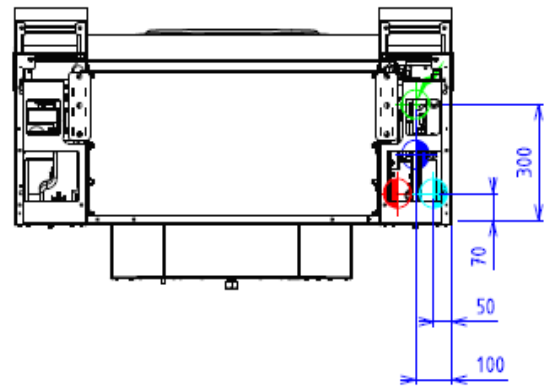
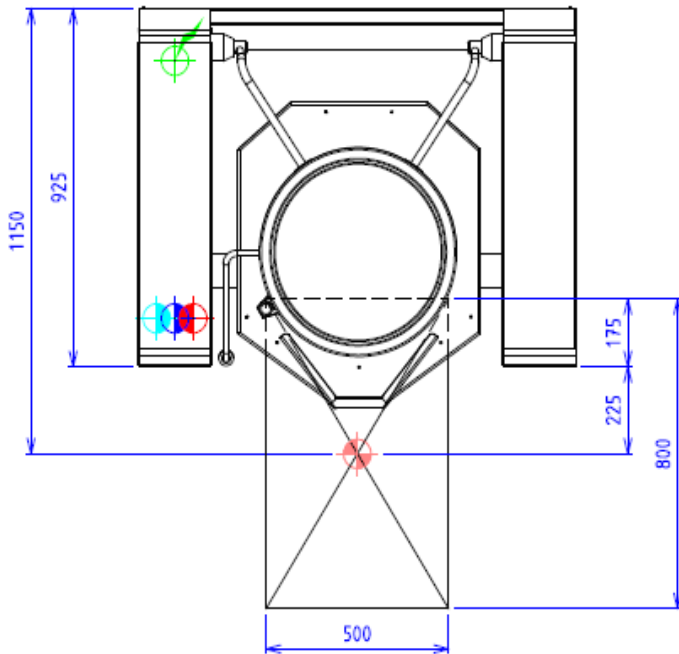
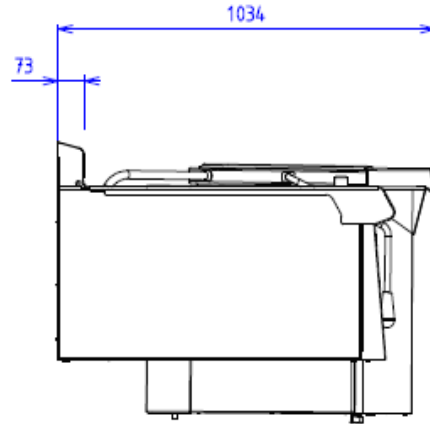
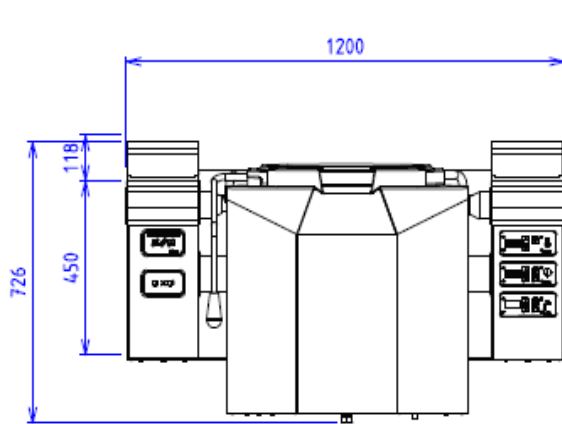

## ELECTRIC



Electric power : 14.00kW

Elec Réservation : INTERNAL TERMINAL BOARD - Elec fitting  
: 400V THREE phases + NEUTRAL

Electrical devices standard to the norm EN 60-335

## WATER/AIR



Hot water fitting :15/21 FLEXIBLE



Cold water fitting :15/21 FLEXIBLE



Double jacket connection in softened water :15/21 FLEXIBLE

Prévoir un régulateur de pression réglé à 1.8 Bar maxi pour le circuit de la double enveloppe