

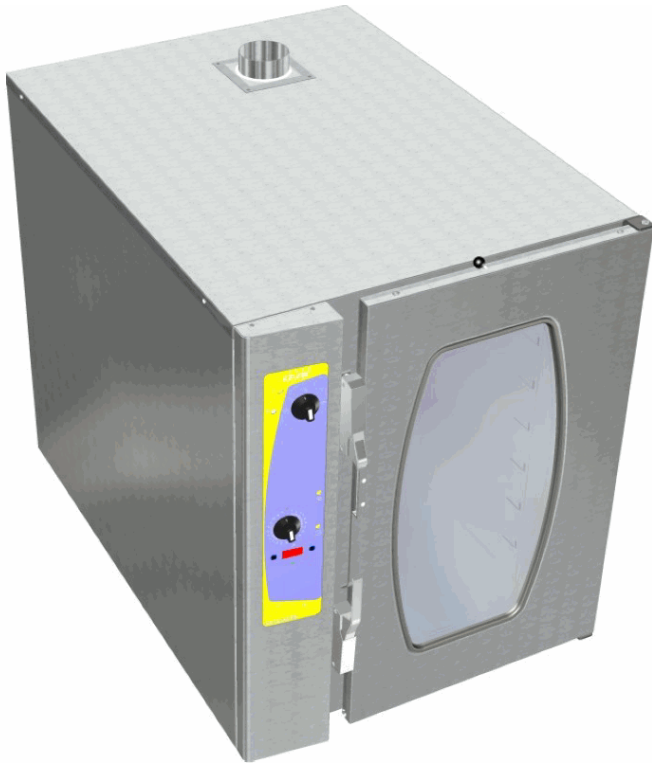

The reference in catering equipment

PATISMATIC 10 LEVELS 600x400 WITHOUT STAND - WITH 10 DRIP TRAYS

PATISMATIC



Descriptions :

Dimensions: 780 x 1110 x 960

Power: 18.0 KW

10 levels spaced at 70

Manufactured in stainless steel F17

Retort in alumina sheet metal 20/10 thick

Covering 10/10 Door 10/10 Base 20/10

Insulation of the door and of the retort

by non-putrescible mineral fibers

Ventilation by stainless steel reverse action tumble turbine

Evacuation of the vapours by adjustable air outlet

Control by electronic thermostat with digital display

Options :

Stand in stainless steel height 750: X110103

Door hinged on left: X100120

Black metal baking sheet: X900202

Storage rack: X100102

Humidity by water atomization: X101301

PATISMATIC 10 NIV 600x400
SANS PIETEMENT - AVEC 10 PLAQ

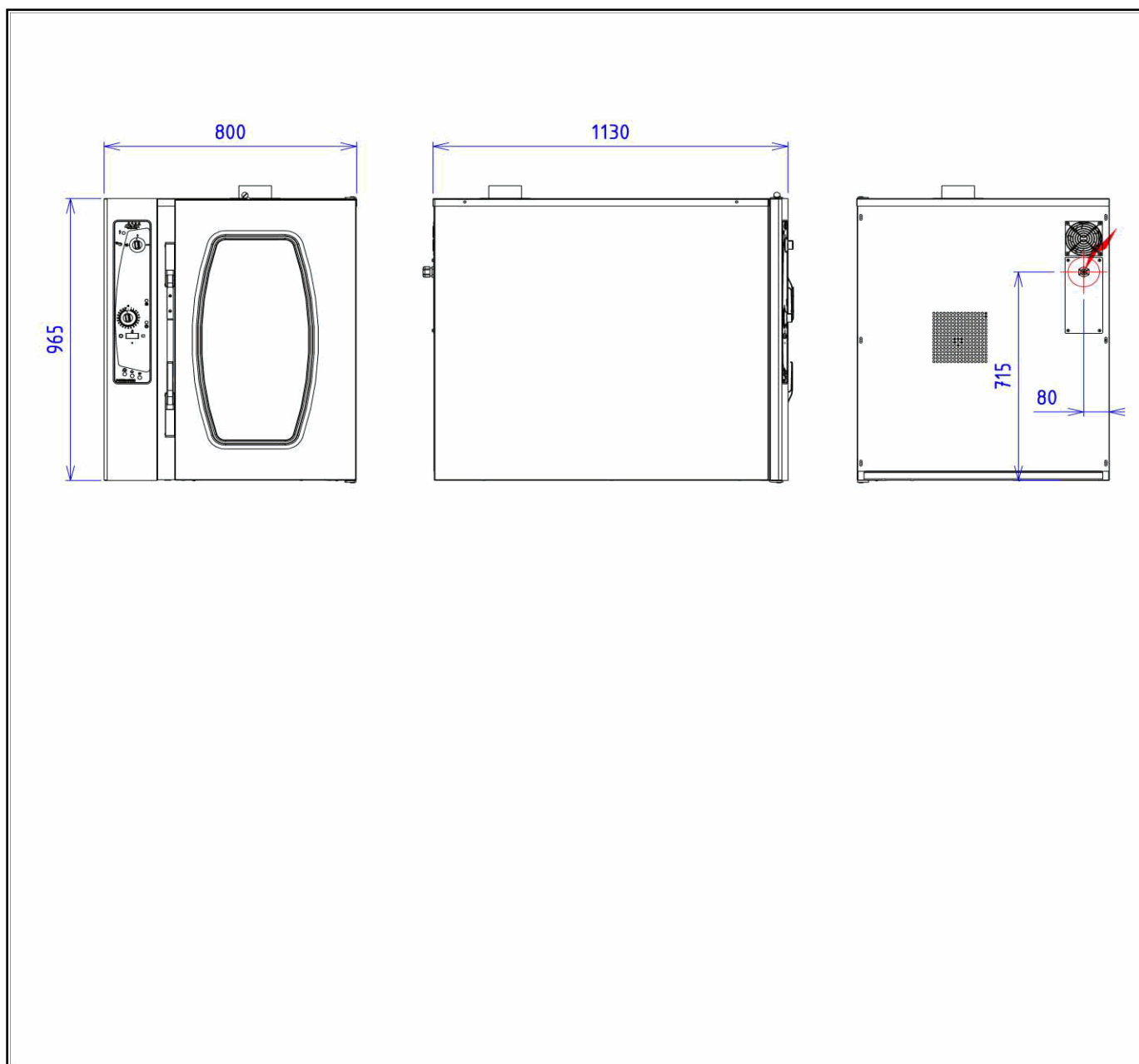
**ELEC**

Electric power : 18,00 kW

Elec type : 400V TRI

Electrical reserving : 400Vx3 N 2M CABLE 0.15M SOL

WATER / AIR

Air to extract : 750,00 m3/h