

ARMEN AM20 FRYER TWO TANKS 25L

MANUAL RAISING CLOSED CUPBOARD

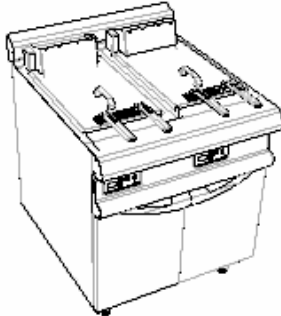

Characteristics

External dimensions : 800 X 925 X 900
 Stainless steel top 18.10 planetary planetary brushed finish
 Top thickness : 3 mm
 body 1 mm in planetary brushed stainless steel
 Structure : 2 mm in stainless steel
 Stand with composite feet of 150 adjustable in height
 folded front edge radius 20 mm
 Back edge forming a chimney cover
 Front without any visible screw

Top

2 Net 20L stainless steel tanks thickness 1.5mm
 Power : 2x20 kW
 Efficiency: >100 kg/h 6x6 frozen french fries
 Thermostat 180°C positive security 220°C
 Heating by oblong resistances
 reinforced and tilting
 Double layer removable for cleaning
 Draining by 1/4 turn tap diam 20/27
 2 stainless steel baskets dimension : 360x285x135

Options :

infrared heating lamp for storage unit for pre-equipped salting unit (W042403)

Base unit

Construction in stainless steel 18.10
 Structure 2 mm
 body 1 mm
 Front without any visible screw
 Double skin doors

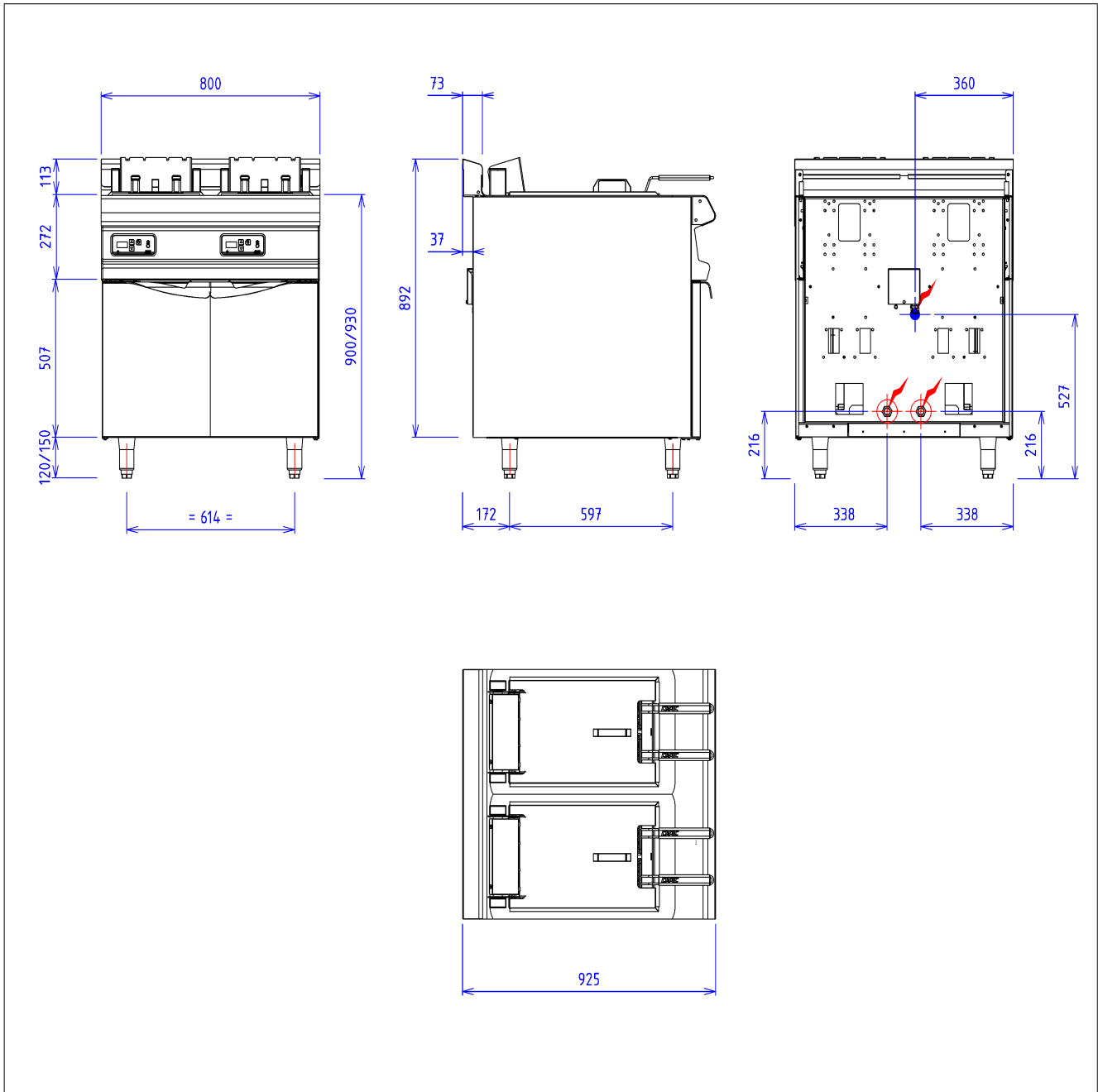

ELECTRIC



Electric power : 40.00kW

Elec Réserve : INTERNAL TERMINAL BOARD - Elec fitting
: 400V THREE phases + NEUTRAL

230V SINGLE(Si option électrique sélectionnée)

Electrical devices standard to the norm EN 60-335