



The reference in catering equipment

CELTIC 800 FRONT 400

CELTIC C6 NEUTRAL UNIT 400
TOP ONLY

Descriptions :

External dimensions : 400x836x270
Top in brushed 18.10 stainless steel
Top thickness 3 mm
body 1 mm in brushed stainless steel
Structure 2 mm in stainless steel
folded front edge radius 20 mm
Back edge forming a chimney cover
Front without any visible screw

Options :

Electric plug (X330311)

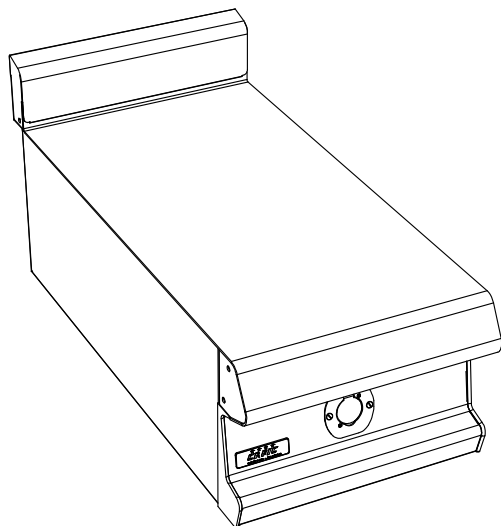

ELEC :  230V Mono +T if electric plug option

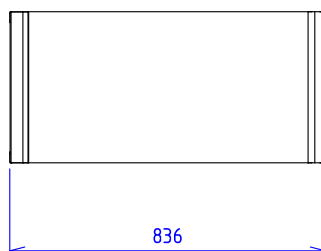
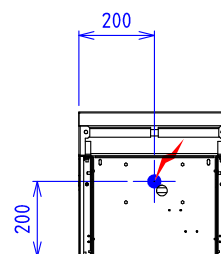
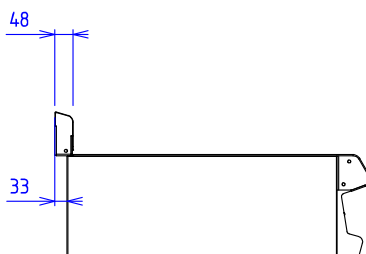
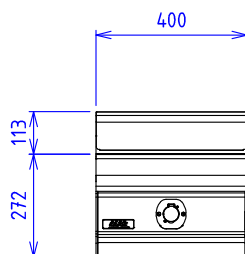

Electrical devices standard to the norm EN 60-335

The emblems, descriptions and diagrams of this documentation are given for your information and could be modified without notice.



69, av. des sports- 29556 QUIMPER CEDEX9-FRANCE
tel.:02.98.64.77.00 - fax: 02.98.52.06.47 e-mail : capic@capic-fr.com