

AVEN 700 AV24 4 OPEN BURNERS + FRENCH HOT TOP ON GAS OVEN

Characteristics

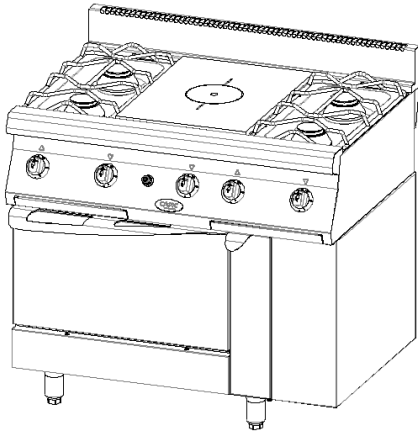

External dimensions : 1000 X 725 X 900
 Construction in planetary brushed stainless steel 18.10
 Top thickness : 2 mm
 Front : 1 mm planetary brushed finish
 Structure : 1 mm in stainless steel
 Back edge forming a chimney cover
 Front without any visible screw

Top

2 open burners on right
 2 open burners on left
 removable burners with pilot light 4x4,8kw
 Stainless steel burner grill dimensions : 300x550
 cleaning tray
 Solid top made of steel, dimensions : 400x550
 Power 6.0 kW
 Heating by circular burner
 Fireplace with brick refractory
 regulated flow by a 3-positions tap
 Security by thermocouple with pilotlight
 Ignition by spark battery (type AA)

Base unit

Dimensions of the oven : 530x450x290
 Walls insulated with mineral fibers
 aluminium steam barrier
 Power 8.0 kW thermostat 50 à 300°C
 Removable steel bottom 6 mm thickness
 Gas ramps great thickness in stainless steel
 Security pilot and thermocouple
 stainless steel lateral walls
 with levels holding griddles
 Door to double wall insulated and balanced
 Provided with one stainless steel griddle
 Electric ignition with battery

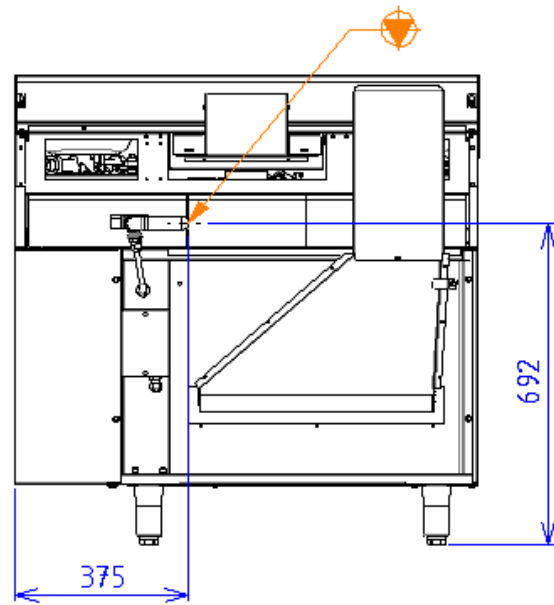
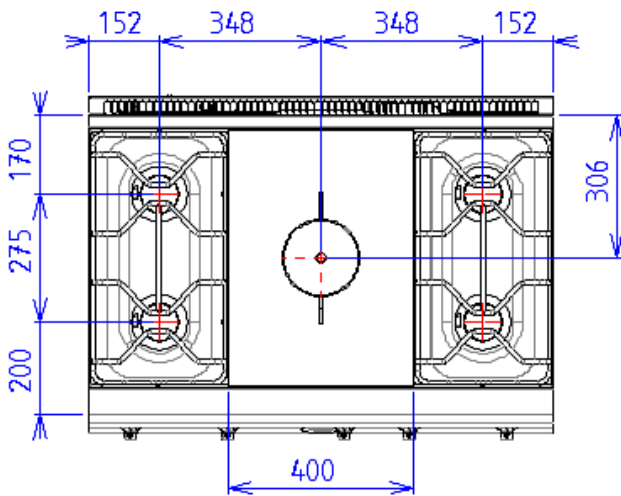
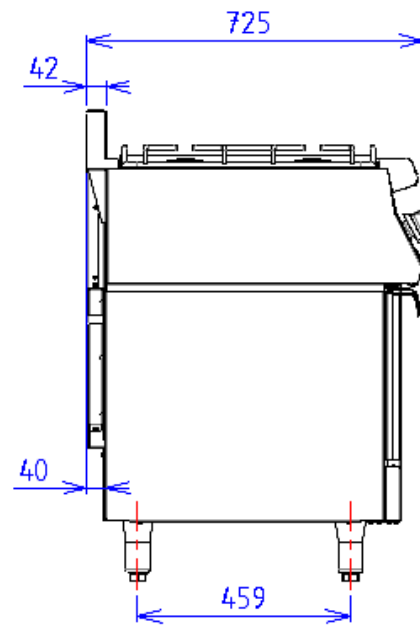
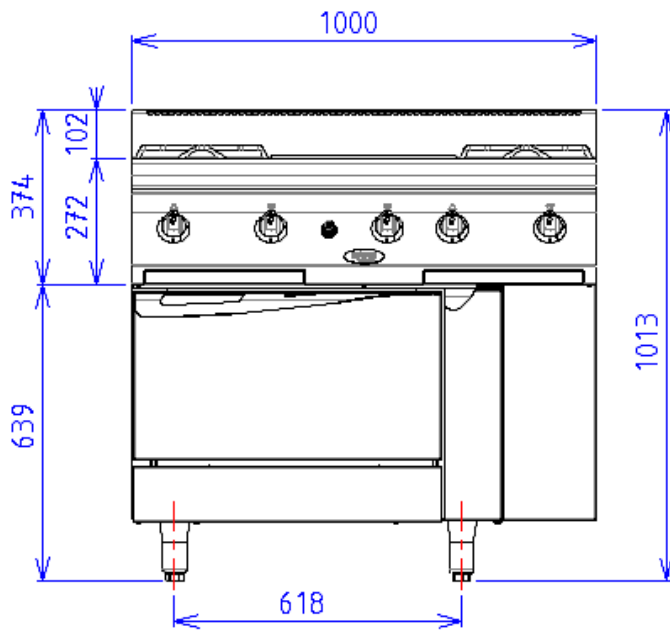

GAS



Gas power : 33.20kW

Gas connection : 20/27 MALE TAPERING

Gas appliances complying with standard NF EN 203.EN 437

Gas Directive 2009/142/EC