



The reference in catering equipment

ARMEN AM17W INDUCTION WOK

TOP ONLY

**ARMEN 900**

**FRONT 400**

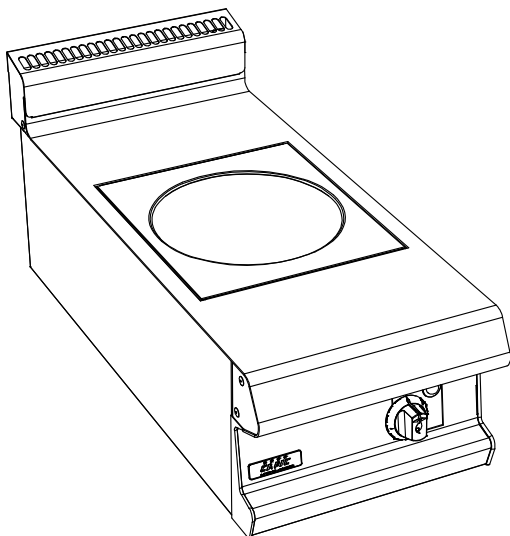

**Descriptions :**

External dimensions : 400x925x270

Top in brushed 18.10 stainless steel

Top thickness 3 mm

body 1 mm in brushed stainless steel

Structure 2 mm in stainless steel

folded front edge radius 20 mm

Back edge forming a chimney cover

Front without any visible screw

**Top :**

Power : 5 kW

Regulation obtained by a calibrated potentiometer

Detection of containers

Thermostatic security

LED heat indicator

**Base unit :**

**Options :**

## ARMEN AM17W INDUCTION WOK TOP ONLY

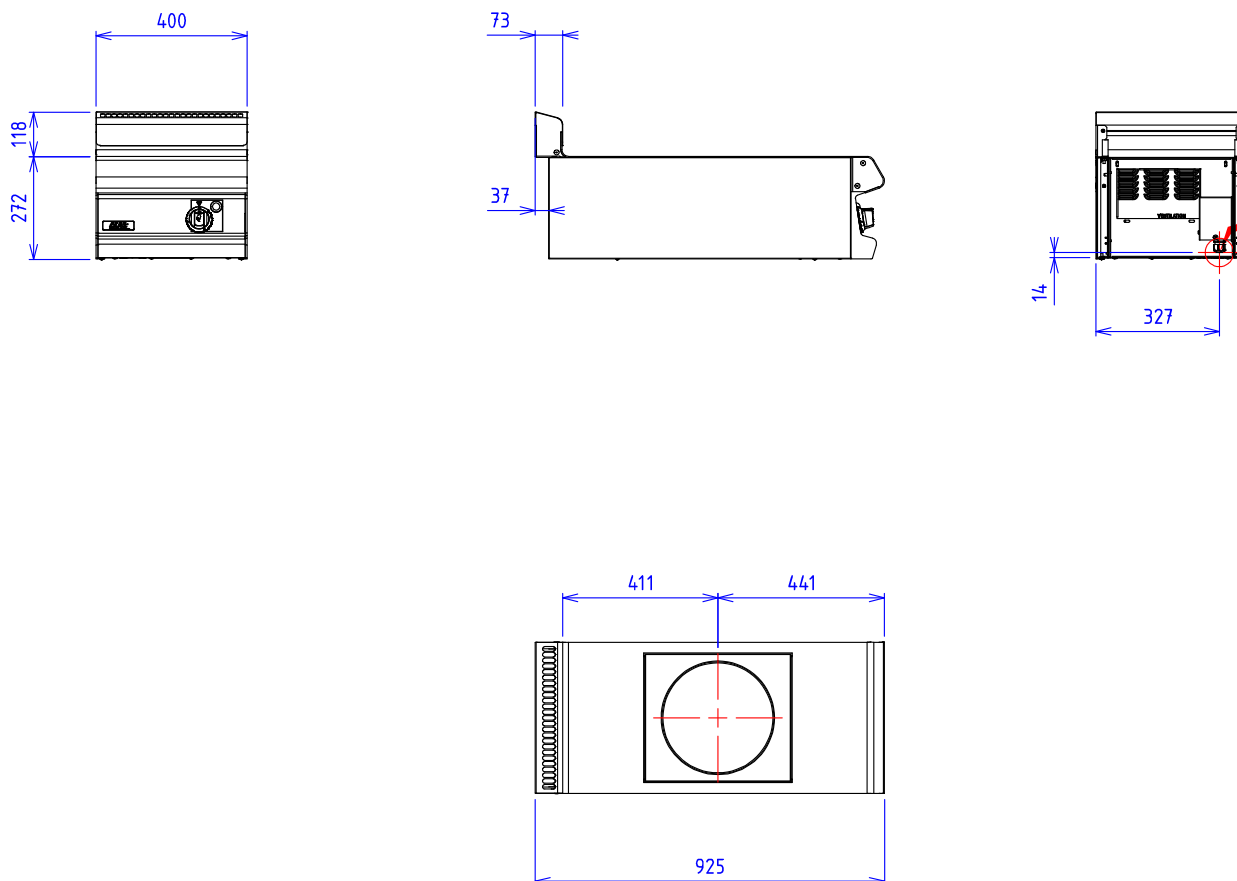

### **GAS :**

**ELEC :**  Electric power : 5 kW Elec reservation : internal wiring Elec fitting : 400Vx3+N+T

Electrical devices standard to the norm EN 60-335

### **WATER :**