



The reference in catering equipment

## ARMEN 900 FRONT 500

ARMEN AM6 NEUTRAL UNIT 500  
TOP ONLY

### Descriptions :

External dimensions : 500x925x270  
Top in brushed 18.10 stainless steel  
Top thickness 3 mm  
body 1 mm in brushed stainless steel  
Structure 2 mm in stainless steel  
folded front edge radius 20 mm  
Back edge forming a chimney cover  
Front without any visible screw

### Options :

Electric plug (X330311)

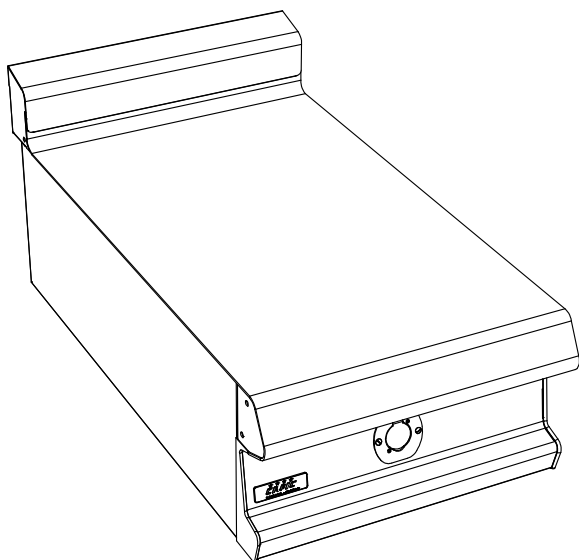

**ELEC :**  230V Mono +T if electric plug option

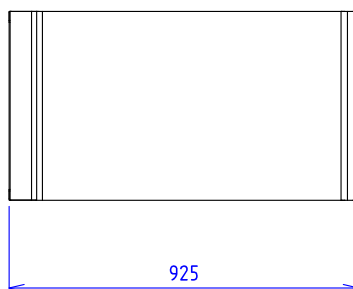
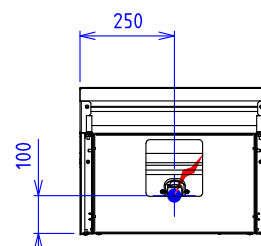
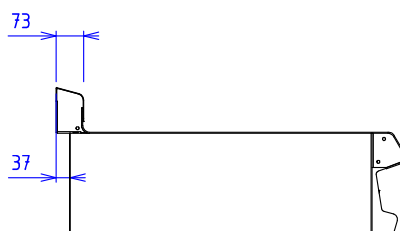
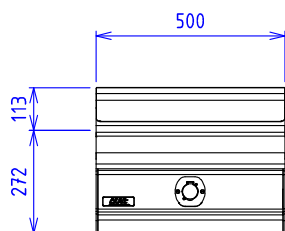

Electrical devices standard to the norm EN 60-335

The emblems, descriptions and diagrams of this documentation are given for your information and could be modified without notice.



69, av. des sports- 29556 QUIMPER CEDEX9-FRANCE  
tel.:02.98.64.77.00 - fax: 02.98.52.06.47 e-mail : capic@capic-fr.com