



The reference in catering equipment

ARMEN 900 FRONT 200

ARMEN AM6 NEUTRAL UNIT 200
TOP ONLY

Descriptions :

External dimensions : 200x925x270
Top in brushed 18.10 stainless steel
Top thickness 3 mm
body 1 mm in brushed stainless steel
Structure 1 mm in stainless steel
folded front edge radius 20 mm
Back edge forming a chimney cover
Front without any visible screw

Options :

Electric plug (X330311)

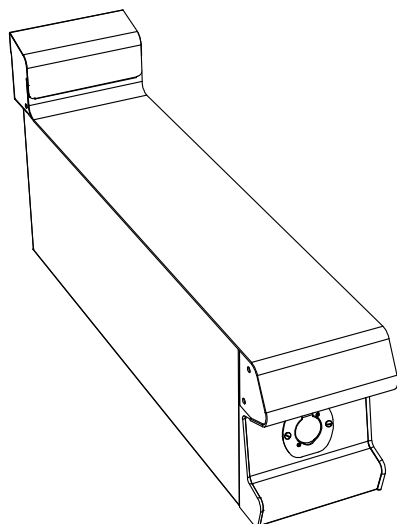

ELEC :  230V Mono +T if electric plug option

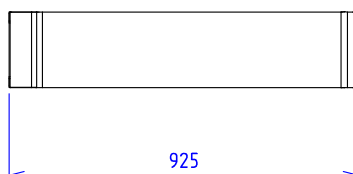
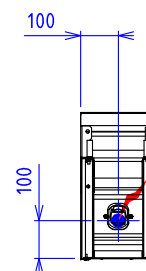
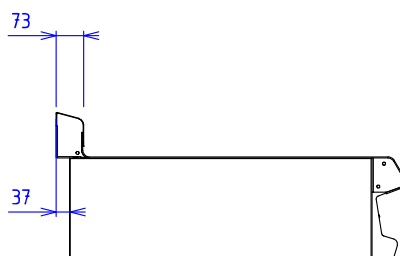
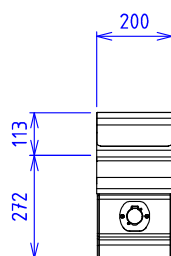

Electrical devices standard to the norm EN 60-335