

Characteristics

External dimensions : 100 X 925 X 270
 Stainless steel top 18.10 planetary planetary brushed finish
 Top thickness : 3 mm
 body 1 mm in planetary brushed stainless steel
 Structure : 1 mm in stainless steel
 folded front edge radius 20 mm
 Back edge forming a chimney cover
 Front without any visible screw

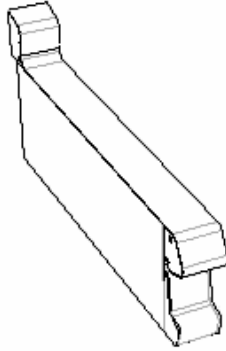

Options :

s/s steel trim bardiam 38 - linear meter (X081001)
 lateral swing doorfor technical cupboard (X081111)
 neutral unit cut outin technical cupboard (X081112)
 goose neck watertaprotating (X902001)
 cold&hot water supply on water column 500mm (X902002)

