



Characteristics

External dimensions : 400 X 925 X 270
Stainless steel top 18.10 planetary planetary brushed finish
Top thickness : 3 mm
body 1 mm in planetary brushed stainless steel
Structure : 2 mm in stainless steel
folded front edge radius 20 mm
Back edge forming a chimney cover
Front without any visible screw

Top

2 open burners
removable burners with pilot light 2x9kw
Burner griddles in stainless steel, dimensions : 400x600
Stamped tank & cleaning tray
Security by thermocouple with pilotlight
secured and protected commands

Options :

water bowl for burner 9kw (X901404)
gaz connection kitfor hose per device (X901405)
electric ignition gas burnereach other gas burner (X901502)

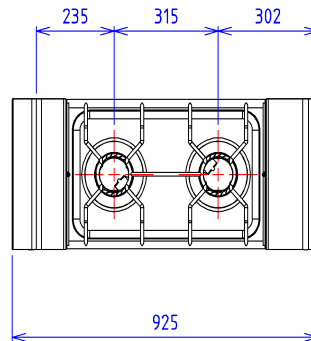
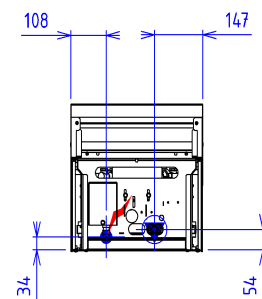
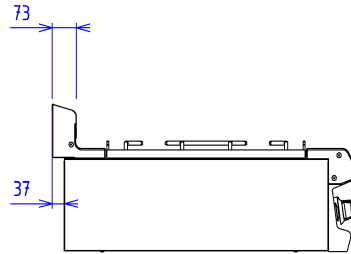
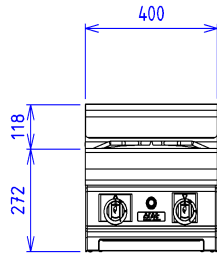

GAS



Gas power : 18kW

Gas connection : 15/21 MALE TAPERING

Gas appliances complying with standard NF EN 203.EN 437

Gas Directive 2009/142/EC

ELECTRIC



Electric power : 0.00kW

Elec Réserve : - Elec fitting :

230V SINGLE(Si option électrique sélectionnée)

Electrical devices standard to the norm EN 60-335