



Characteristics

External dimensions : 400 X 925 X 270

Stainless steel top 18.10 planetary planetary brushed finish

Top thickness : 3 mm

body 1 mm in planetary brushed stainless steel

Structure : 2 mm in stainless steel

folded front edge radius 20 mm

Back edge forming a chimney cover

Front without any visible screw

Top

2 open burners

removable burners with pilot light 2x6kw

Burner griddles in stainless steel, dimensions : 400x600

Stamped tank & cleaning tray

Security by thermocouple with pilotlight

secured and protected commands

Options :

gaz connection kitfor hose per device (X901405)

electric ignition gas burnereach other gas burner (X901502)

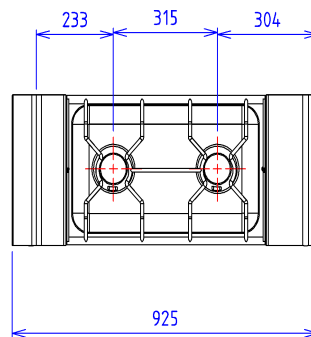
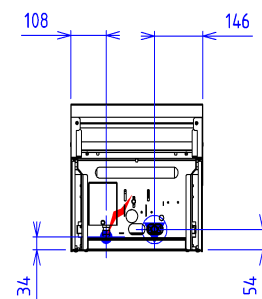
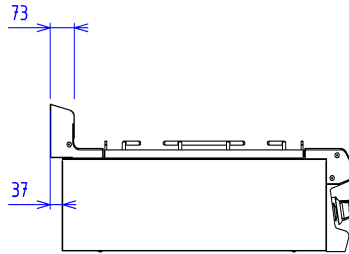
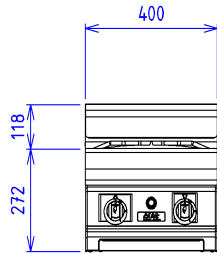

GAS



Gas power : 12kW

Gas connection : 15/21 MALE TAPERING

Gas appliances complying with standard NF EN 203.EN 437

Gas Directive 2009/142/EC

ELECTRIC



Electric power : 0.00kW

Elec Réserve : - Elec fitting :

230V SINGLE(Si option électrique sélectionnée)

Electrical devices standard to the norm EN 60-335